

# Remove any jammed paper in the Inner Finisher

## CAUTION

- Do not reuse jammed papers.
- If the paper tears during removal, be sure to remove any loose scraps of paper from inside the machine. Scraps of paper left in the machine could cause subsequent jamming.

### 1 Remove any jammed paper.

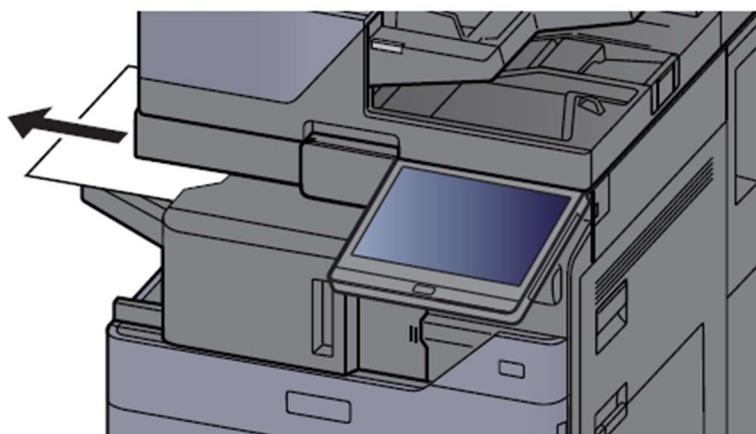

### 2 Open the inner finisher unit.

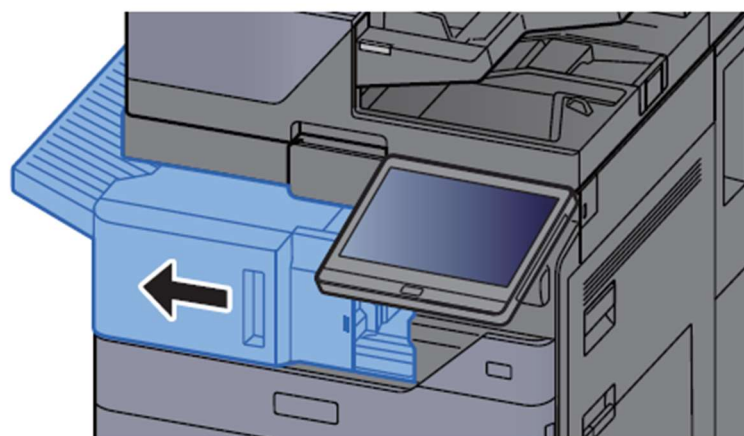

### 3 Remove any jammed paper.

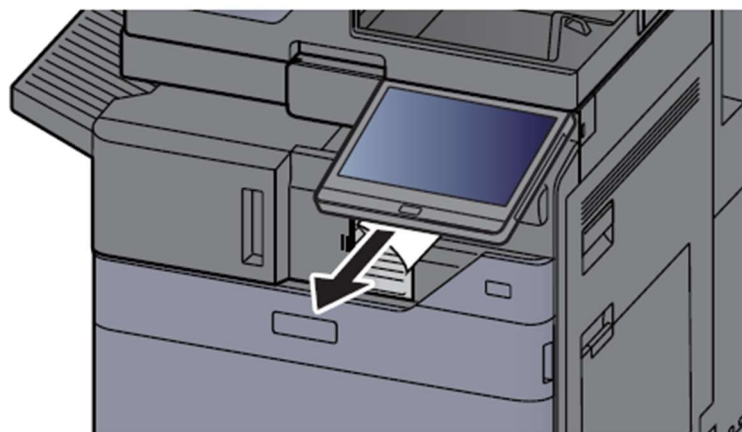

**4** Return the unit to the original position.

